

80 VICTORIA ST

SW1



A VICTORIA LANDMARK

Developed by LandSec, 80 Victoria Street is a landmark office building located within the Cardinal Place development. The available space on the part 7th floor (West) offers 22,434 sq ft of contemporary office accommodation, which has been delivered to a Cat A specification. The space offers a private terrace and winter garden. Welcomed by the impressive reception, this building is amenity rich providing excellent end of journey facilities and a communal business lounge and café.



Building exterior

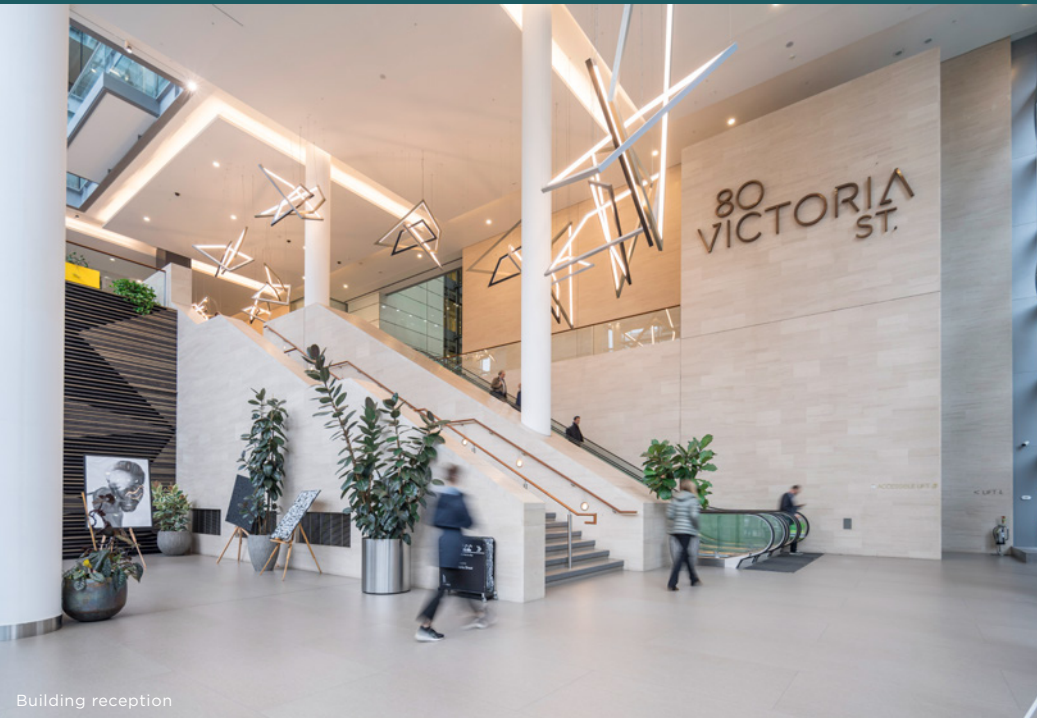

Building reception



Business lounge & café



Communal business lounge & café



2.7m floor to ceiling height



Shower, cycle and changing facilities



Winter garden



Private terrace



Impressive building reception and concierge



BREEAM Very Good

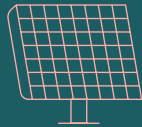

Fully powered by renewable energy



312 cycle racks



263 lockers



Newly delivered to a Cat A specification



4 pipe fan coil air conditioning



View overlooking Westminster Cathedral



Eastern unit private terrace



View overlooking Cardinal Place



Central atrium





7TH FLOOR - CAT A

WEST

22,434 sq ft
2,084.2 sq m

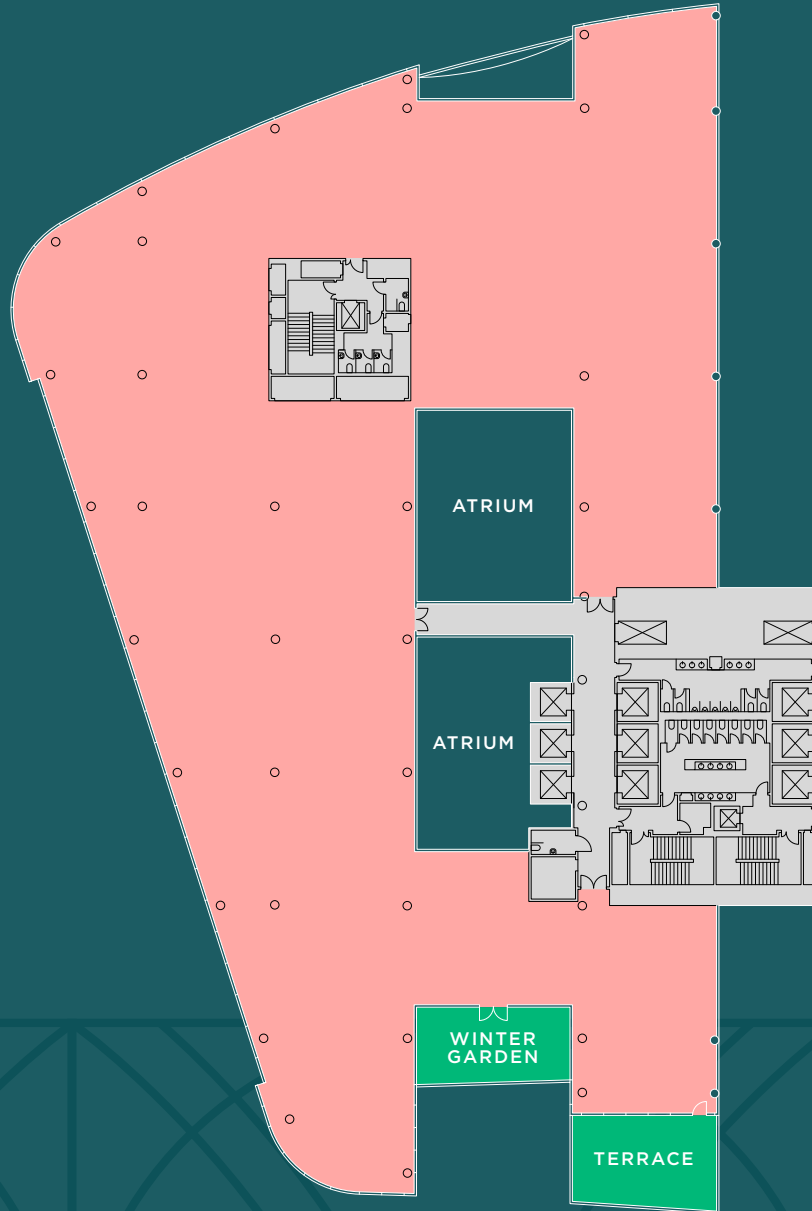

VICTORIA STREET



7TH FLOOR INDICATIVE LAYOUT

WEST

- 266x Workstations
- 12x Meeting rooms
- 1x Boardroom
- 13x Work booths
- 2x Collaboration areas
- 7x Breakout areas
- 2x Teapoints
- 1x Reception

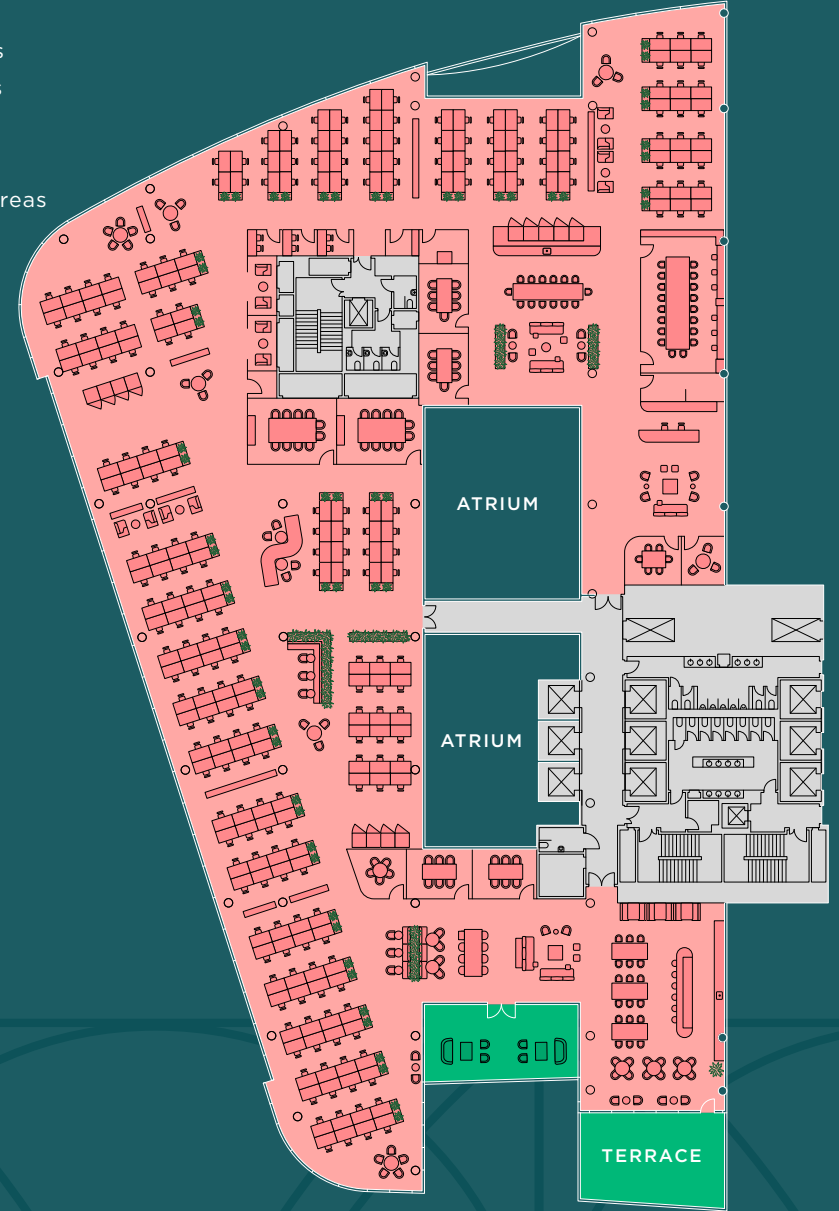

VICTORIA STREET



Bone Daddies



Gymbox

80 Victoria Street enjoys a prime location in the heart of Victoria, a lively area bustling with new retail and dining options, including the popular Nova and Cardinal Place developments. For green space, St James's Park is moments away and connectivity is excellent with Victoria Station on the door step.



The Goring

LOCATION, LOCATION, LOCATION



The Ivy



Market Halls



St James's Park



Cardinal Place



LOCAL AMENITIES

Restaurants

- Muse by Tom Aikens
- Oliviomare
- Santini
- Harry's
- The Goring Dining Room
- Timmy Green
- Bone Daddies
- Nova Food Court
- Market Halls Victoria
- Bon Gusto
- Quilon
- Urban Greens
- Chez Antionette
- Ibérica
- The Ivy
- Yaatra
- Boisdale of Belgravia
- Eccleston Yards
- Hatch 77
- Vincent Rooms

Bars

- The Alchemist
- Vagabond
- Greenwood
- Flight Club
- Pavlova's
- The Hampton's Bar

Retail

- Eccleston Yards
- Victoria Place
- Cardinal Place

Hotels

- The Goring
- Hotel 41
- The Guardsman
- Taj 51
- St. Ermin's
- The Wellington

Leisure

- Buckingham Palace
- The Royal Mews
- The Guards Museum
- Victoria Palace Theatre
- Little Ben
- Apollo Theatre
- Curzon
- Westminster Cathedral
- Eccleston Yards

Cafés

- Koub
- Joe & The Juice
- Gail's
- The English Rose
- Ole & Steen
- Pret a Manger
- Old Queen Street Cafe

Gyms

- Barry's
- Manor
- Frame
- 1Rebel
- City Athletic
- Gymbox

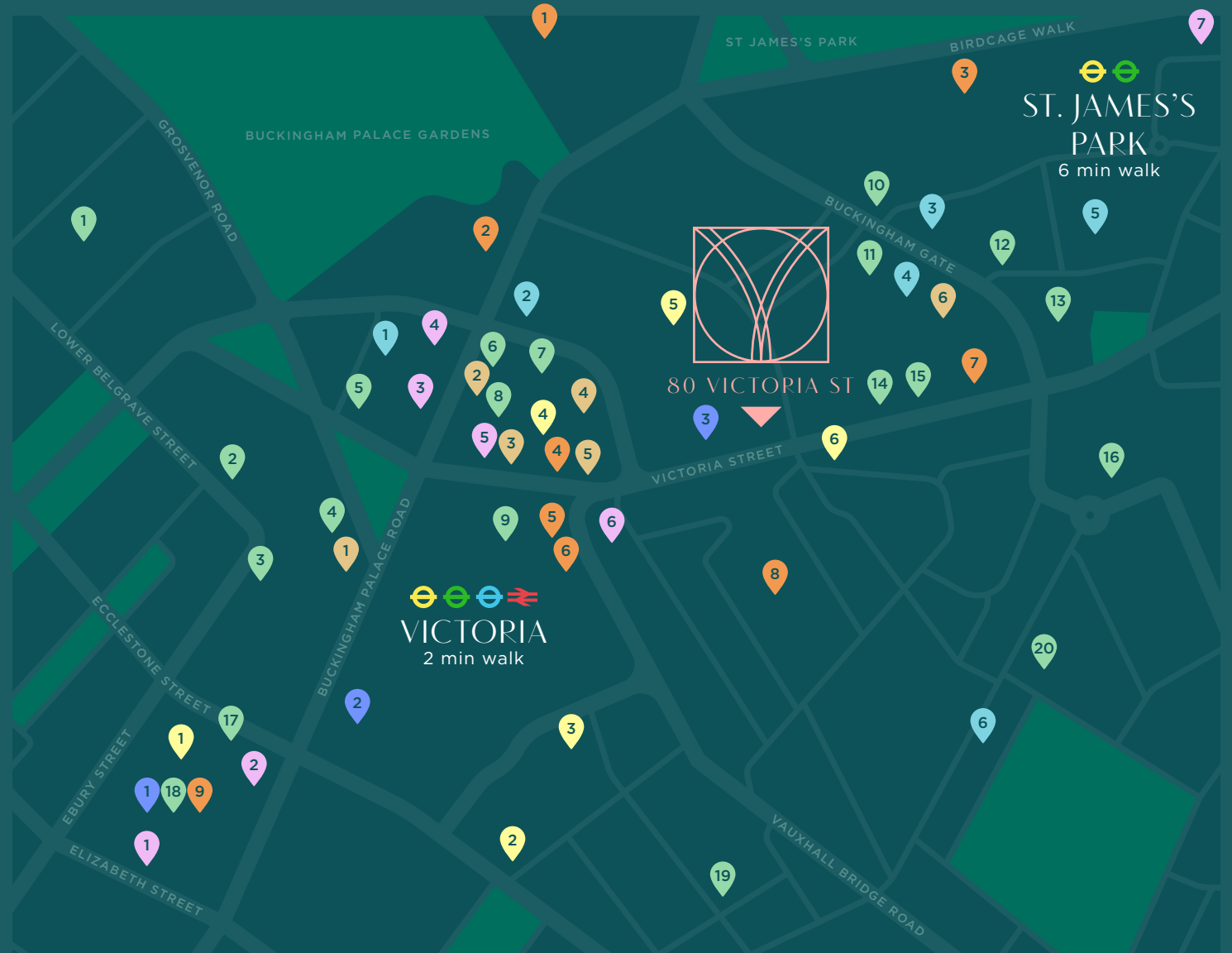



80 VICTORIA ST

SW1

Available on an Assignment until December 2031 (Inside the Act)

CBRE

**CROSSLAND
OTTER HUNT**

NATHALIE SPINK

nathalie.spink@cbre.com

07385 414222

LUKE HACKING

luke.hacking@cbre.com

07951 224060

CHARLOTTE STEELE

charlotte@coh.eu

07503 625481

RICHARD LOCKHART

richard@coh.eu

07780 661096

CBRE and Crossland Otter Hunt on their behalf and for the Vendors or Lessors of this property whose agents they are, give notice that: 1. These particulars are set out as a general outline only for guidance to intending Purchasers or Lessees, and do not constitute any part of an offer or contract. 2. Details are given without any responsibility and any intending Purchasers, Lessees or Third parties should not rely on them as statements or representations of fact, but must satisfy themselves by inspection or otherwise as to the correctness of each of them. 3. No person in the employment of CBRE and Crossland Otter Hunt has any authority to make any representation or warranty whatsoever in relation to this property. 4. Unless otherwise stated, all prices and rents are quoted exclusive of VAT. January 2026.